

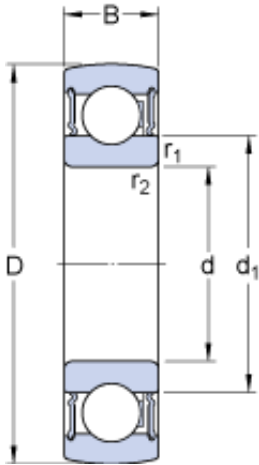

NRAT BEARING CO.,LTD.



20 mm x 47 mm x 14 mm SKF 1726204-2RS1 ITALY Bearing

Bearing No. 1726204-2RS1

1726204-2RS1 Bearing 2D drawings and 3D CAD models

Size	47x20x14 mm
Bore Diameter	47 mm
Outer Diameter	20 mm
Width	14 mm
d	20 mm
D	47 mm
B	14 mm
d ₁	28.8 mm
r _{1,2} - min.	1 mm
Basic dynamic load rating - C	12.7 kN
Basic static load rating - C ₀	6.6 kN
Fatigue load limit - P _u	0.28 kN
Limiting speed	10000 r/min
Calculation factor - f ₀	13
Category	Insert Bearings Spherical OD
Inventory	0.0
Manufacturer Name	SKF
Minimum Buy Quantity	N/A
Weight / Kilogram	0.1
Product Group	B00308
Inner Race Profile	Standard Inner Ring
Outer Race Profile	Spherical
Relubricatable	No



NRAT BEARING CO.,LTD.

Seal Type	RS1 Seal
Mounting Method	Shaft Mount
Rolling Element	Ball Bearing
Snap Ring	No
Long Description	20MM Bore; Standard Inner Ring; Ball Bearing; 14MM Length Thru Bore; 14MM Outer Race Width; 47MM Outside Diameter; Not Relubricatable; RS1 Seal; Shaft Mount Mounting Method; No Snap Ring
Inch - Metric	Metric
Other Features	Single Row Standard Duty Metric
Category	Insert Bearings
UNSPSC	31171536
Harmonized Tariff Code	8482.10.50.00
Noun	Bearing
Keyword String	Insert
Manufacturer URL	http://www.skf.com
Manufacturer Item Number	1726204-2RS1
Weight / LBS	0.209
Outside Diameter	1.85 Inch 47 Millimeter
Outer Race Width	0.551 Inch 14 Millimeter
Bore	0.787 Inch 20 Millimeter
Length Thru Bore	0.551 Inch 14 Millimeter
bore diameter:	20 mm
internal clearance:	C0
outside diameter:	47 mm
operating temperature range:	-40 to +210 ° F
overall width:	14 mm
finish/coating:	Uncoated
bore type:	Round



NRAT BEARING CO.,LTD.

outer ring width:	14 mm
closure type:	Double Sealed
maximum rpm:	10000 RPM
row type & fill slot:	Single Row Non-Fill Slot
series:	17262
snap ring included:	Without Snap Ring
d_1	28.8 mm
$r_{1,2}$ min.	1 mm
Basic dynamic load rating C	12.7 kN
Basic static load rating C_0	6.55 kN
Fatigue load limit P_u	0.28 kN
Limiting speed ¹⁾	10000 r/min
Calculation factor f_0	13
Mass complete bearing	0.1 kg